

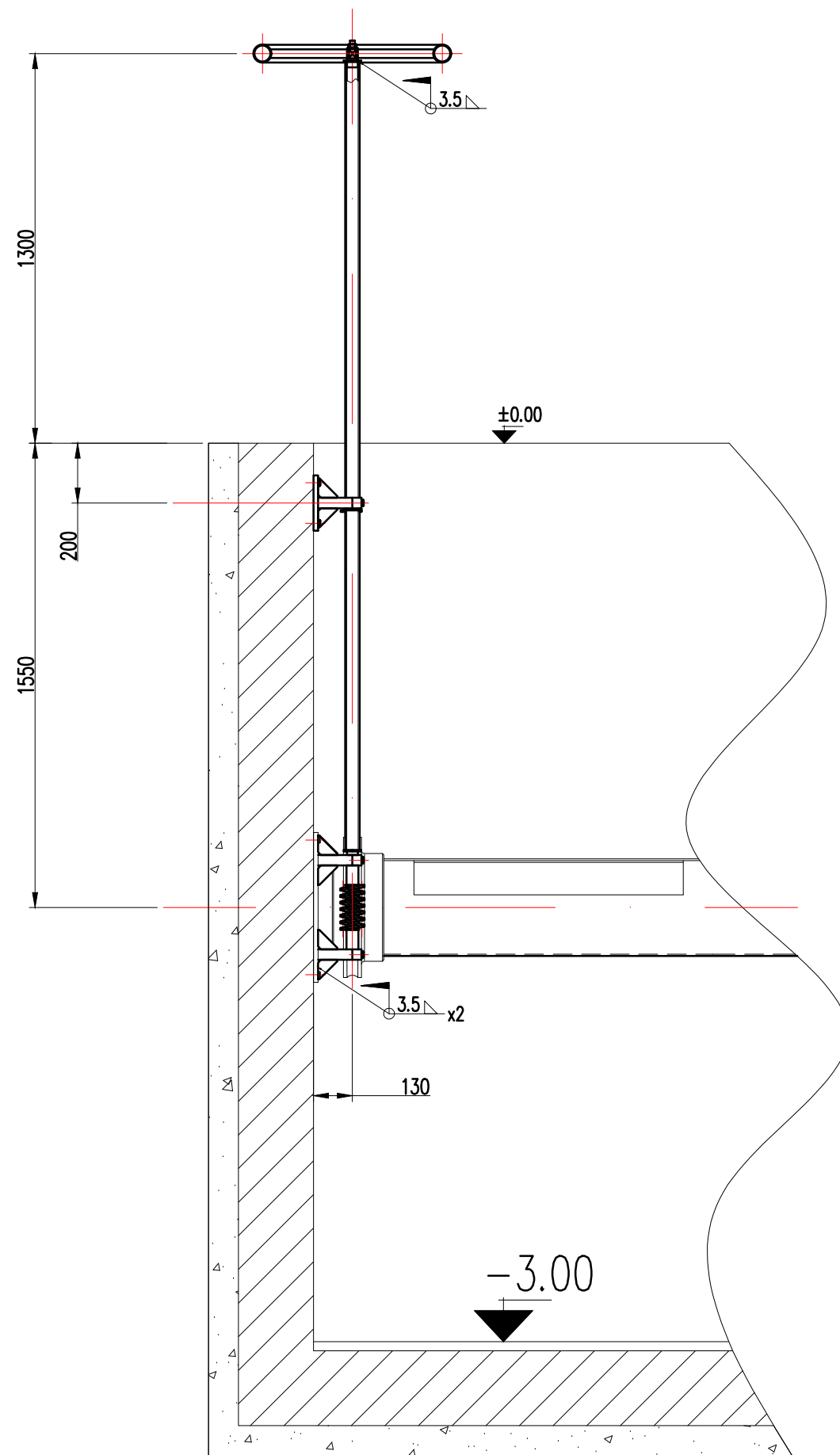

ACEST DOCUMENT ESTE PROPRIETATEA SOCIETATII ELLIS'92 S.R.L.-PLOESTI. IN CONSECINTA, FIRMA ARE DREPTUL EXCLUSIV DE FOLOSIRE A DESENULUI SAU DE OPERARE A EVENTUALELOR MODIFICARI DIN CAMPIUL ACESTUIA.

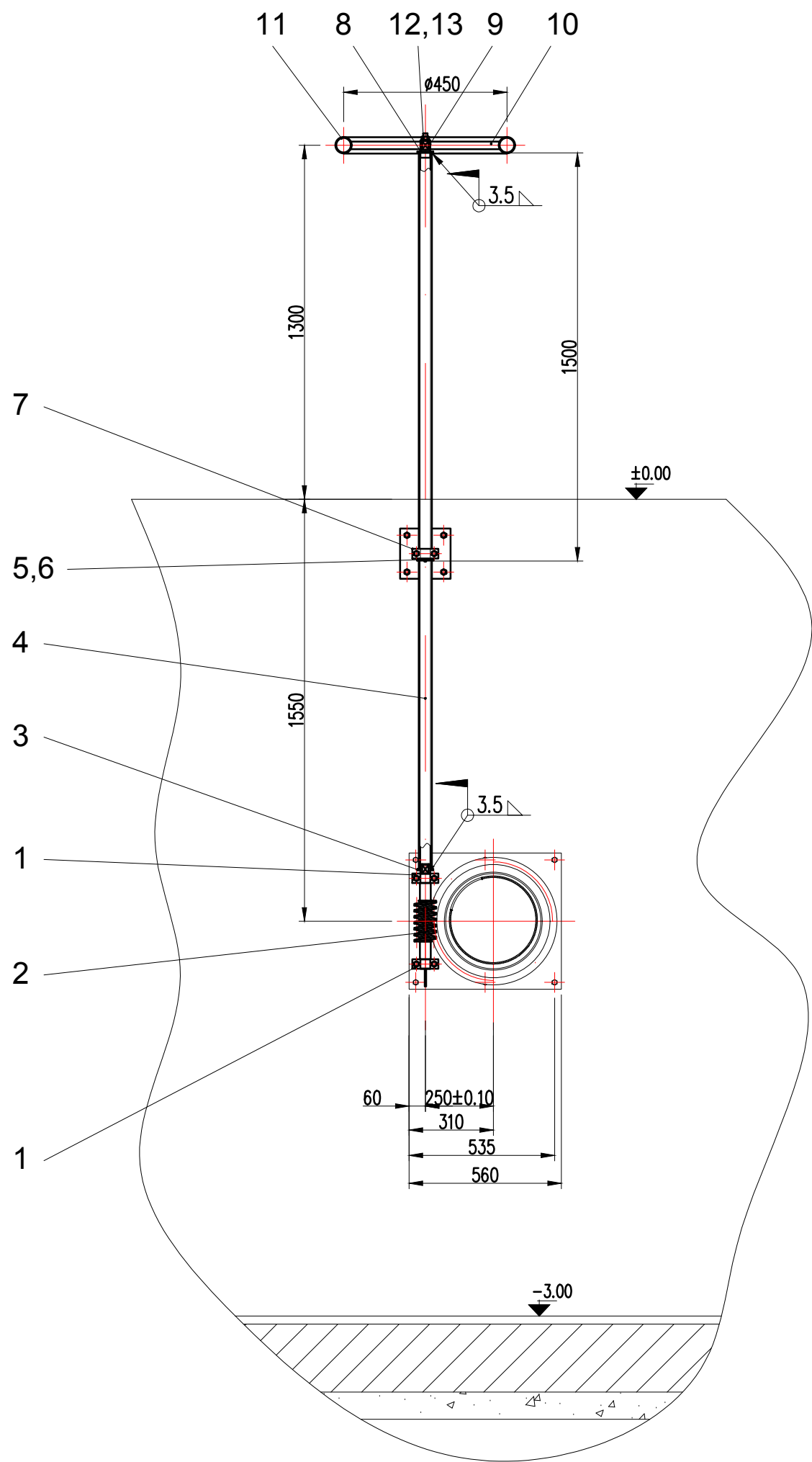
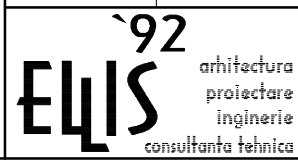

	Electrozi					1.00	
13	Piulita M16	SR EN ISO 4034	1	gr. 8		0.033	
12	Saiba plata A16	SR EN ISO 7091	1	S235JRH		0.011	
11	Roata	A636.4-DT-05.04.11	1	S235JRH		5.05	
10	Spita	A636.4-DT-05.04.10	3	S235JRH		0.28	
9	Bucsa 2	A636.4-DT-05.04.09	1	S235JR		0.16	
8	Ax	A636.4-DT-05.04.08	1	S235JR		0.47	
7	Lagar 2	A636.4-DT-05.04.07	1			7.75	
6	Splint 5x63	SR EN ISO 1234	1	S235JR		0.016	
5	Saiba Ø60xØ50x5	—————	1	S235JR		0.035	
4	Tija	A636.4-DT-05.04.04	1	S235JRH		12.45	
3	Bucsa 1	A636.4-DT-05.04.03	1	S235JR		0.235	
2	Melc	A636.4-DT-05.04.02	1	1C45 cf. SR EN 10083/2		5.75	
1	Lagar 1	A636.4-DT-05.04.01	2			4.00	
Poz.	Denumirea	Nr. desen sau STAS	Buc.	Material	Obs.	Masa neta kg/buc	
3			6				
2			5				
1			4				
Rev.	Descriere	Data	Semnat	Rev.	Descriere	Data	Semnat
Acest document este proprietatea S.C. ELLIS'92 S.R.L. si nu va fi comunicat fara autorizare							
Intocmit	Verificat	Aprobat	Beneficiar		Denumire proiect		
Mircea Parvulescu	Razvan Nita	Androne Ionescu	CONPET S.A.		REABILITARE RAMPA DE INCARCARE TITEI MARGHITA, JUDE. BIHOR		
			COLECTOR DE SLOPS ROATA MANEVRA		Nr.: A636.4-DT-05.04.00		
					Scara: 1:20		
					Index: A636.4-DT-BD		REV.0
		Material:	Masa: 40.90 kg		Data: 06.2018		Plansa: 1/1
						A2 (420x594)	